

# AccuMate PRO

**Versatile  
automatic  
3-stage  
compact  
battery  
chargers for :**



**LEAD-ACID STARTER AND  
DEEP CYCLE BATTERIES OF  
MINIMUM CAPACITY  
10AH (12V) OR 8AH (24V),  
SEALED AGM, FLOODED  
OR GEL.**



## **Models :**

Ref. AMPRO12/24  
12V-6A / 24V-3A  
selectable



Ref. AMPRO12-6  
12V-6A



Ref. AMPRO12-4  
12V-4A



# AccuMate PRO, versatile automatic 3-stage compact battery chargers for 12V and 24V lead-acid starter and deep cycle batteries of all types.

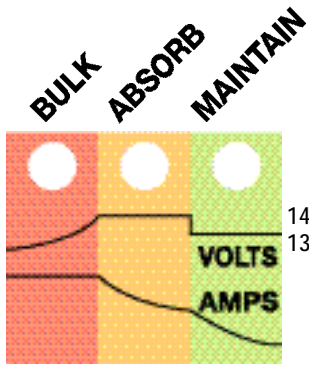

## ◆ 3-step «IUU» charging algorithm with automatic thermal adjustment of voltage settings.

1. Constant current “bulk” charge until the voltage has risen to 14,4V at 20°C.
2. 14,4V absorption stage until the charge current falls to 0,17 x full charge current.
3. Float mode voltage limited at 13,7V. Should the battery being maintained at any stage require current exceeding 0,17 x full charge current, the program reverts to the absorption stage. The battery can then draw current as required until this again reduces to 0,17 x full charge current, whereupon the float mode will again engage.

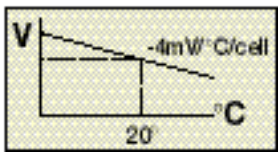

## ◆ An ambient temperature sensor plugs in at the rear of the housing to vary the output voltage parameters by $-4mV/°C/cell$ ( $-2,2mV/°F/cell$ ) deviation in ambient temperature away from the 20°C norm. Unplugging this sensor sets the voltage parameters to the default (20°C) settings.

## ◆ The built-in cooling fan (except 4A model) with sealed ball-bearings (rated for a minimum 5 years of continuous running) ensures cool operation for enhanced service life, while an internal temperature monitor (NTC thermistor) controls the output current and reduces it if necessary to avoid overheating in exceptional circumstances. These features allow compact charger dimensions of 14x16x15 cm (5 1/2” x 6 3/8” x 6” high) including the handle.

## ◆ The easily detachable handle incorporating a cable storage reel & clamp storage can be mounted above the main housing (for carrying) or below (for wall-mounted application), by means of 2 pear-slots in the rear of the housing which engage on two screws in the wall).

## ◆ The standard ambient temperature sensor can be replaced by an optional plug-in 2m (6’ 6”) long external temperature probe for taping on to the battery casing for more accurate automatic charging voltage management.

## ◆ Delivered with 2 detachable connection sets, one with battery clips, the other with eyelets for permanent attachment to a battery’s posts. Extra sets available. Other connection options below.

## ◆ The 2m (6’ 6”) charging output cable can be extended using the optional special extension set (2,5mx2x1,3mm<sup>2</sup> / 8ft x16Awg) to charge batteries 4,5m (15 ft) away.

## ◆ Electronic fuseless protections against inverse polarity, short-circuit, over-heating. Sparks are suppressed.

## ◆ Additional fuse protections provided for : eyelets connection set (protects battery against dead-shortening across terminals in case of accident) ; AC input ; accidental disablement of the built-in cooling fan ; and a thermal fuse protects the transformer.

## ◆ 24 months warranty excluding cables, connectors, sensors & probes.

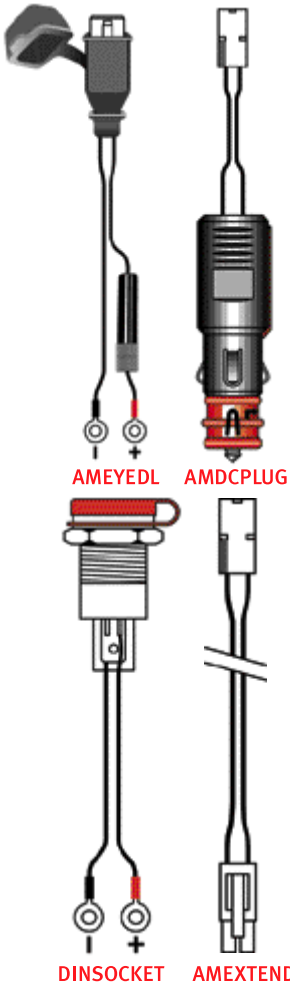
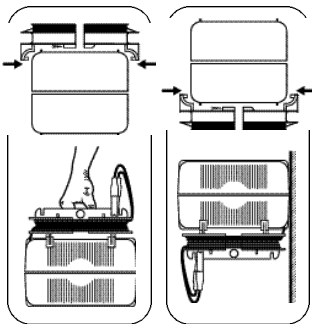

# AccuMate PRO